

CATALOG NUMBER	NAVY CABLE SIZE	ACCOMMODATES	FIG.	STUD SIZE	DIMENSIONS										COLOR CODE & DIE INDEX		DIELESS TOOLS & NO. OF CRIMPS	INSTALLATION TOOLING							WIRE STRIP LENGTH	
					O.D.	B	C	D MIN.	E	K	L	N	T	DIE INDEX	COLOR	TYPE		MD6	MD6-6R2	MD7-34R	OUR840	TOOLS, DIE NO.'S & (NO. OF CRIMPS)				
																						BCT500, Y500CT, PAT600	Y35, Y39, Y750, PAT750, Y45, Y46	Y60BHU		
YA8CLNT6	N23	#8 STR/ #6 SOL	1	6	.27	.44 [11]	.29 [7]	.41 [10]	----	.15 [4]	1.08 [27]	.19 [5]	.09 [2]	49	RED	1	9	W8CRT(1) W8CVT(1)	W8CRT(1) W8CVT(1)	W8CVT(1) W8CRT(1)	X8CRT (1)	W8CRT(1) W8CVT(1)	U8CRT (1)	----	1/2"	
YA8CLNT8	N23	#8 STR/ #6 SOL	1	8	.27	.44 [11]	.33 [8]	.47 [12]	----	.18 [5]	1.18 [30]	.22 [6]	.09 [2]	49	RED	1		W8CRT(1) W8CVT(1)	W8CRT(1) W8CVT(1)	W8CVT(1) W8CRT(1)	X8CRT (1)	W8CRT(1) W8CVT(1)	U8CRT (1)	----	1/2"	
YA6CLNT6	---	#6 STR/SOL	1	6	.29	.54 [14]	.29 [7]	.41 [10]	----	.15 [4]	1.17 [30]	.19 [5]	.09 [2]	7 OR 374	BLUE	1		W5CRT(1) W5CVT(1)	W5CRT(1) W5CVT(1)	W5CVT(1) W5CRT(1)	X5CRT (1)	W5CRT(1) W5CVT(1)	U5CRT (1)	----	9/16"	
YA4CLNT10	N40	#4 STR	1	8-10	.34	.81 [21]	.40 [10]	.64 [16]	----	.20 [5]	1.73 [44]	.31 [8]	.09 [2]	8 OR 346	GRAY	1		W4CRT(1) W4CVT(1)	W4CRT(1) W4CVT(1)	W4CVT(1) W4CRT(1)	X4CRT (1)	W4CRT(1) W4CVT(1)	U4CRT (1)	----	7/8"	
YA3CLNT516	N50	#3 STR	1	5/16"	.38	.88 [22]	.49 [12]	.62 [16]	----	.33 [8]	1.80 [46]	.25 [6]	.09 [2]	9	WHITE	1		----	----	----	----	----	U3CRT (1)	----	15/16"	
YA2CLNT14	N60	#2 STR	1	1/4"	.42	.88 [22]	.50 [13]	.56 [14]	----	.27 [7]	1.80 [46]	.25 [6]	.11 [3]	10	BROWN	1		W2CRT(1) W2CVT(1)	W2CRT(1) W2CVT(1)	W2CVT(1) W2CRT(1)	X2CRT (1)	W2CRT(1) W2CVT(1)	U2CRT (1)	----	15/16"	
YA2CLNT10	N60	#2 STR	1	8-10	.42	.88 [22]	.48 [12]	.56 [14]	----	.20 [5]	1.80 [46]	.25 [6]	.11 [3]	10	BROWN	1		W2CRT(1) W2CVT(1)	W2CRT(1) W2CVT(1)	W2CVT(1) W2CRT(1)	X2CRT (1)	W2CRT(1) W2CVT(1)	U2CRT (1)	----	15/16"	
YA2CL2NT10E2	N60	#2 STR	2	8-10	.42	.88 [22]	.48 [12]	1.32 [34]	.75 [19]	.20 [5]	2.56 [65]	.25 [6]	.11 [3]	10	BROWN	1		W2CRT(1) W2CVT(1)	W2CRT(1) W2CVT(1)	W2CVT(1) W2CRT(1)	X2CRT (1)	W2CRT(1) W2CVT(1)	U2CRT (1)	----	15/16"	
YA2CL2NT14	N60	#2 STR	2	1/4"	.42	.88 [22]	.48 [12]	1.26 [32]	.63 [16]	.27 [7]	2.47 [63]	.31 [8]	.11 [3]	10	BROWN	1		W2CRT(1) W2CVT(1)	W2CRT(1) W2CVT(1)	W2CVT(1) W2CRT(1)	X2CRT (1)	W2CRT(1) W2CVT(1)	U2CRT (1)	----	15/16"	
YA2CL2NT14E2	N60	#2 STR	2	1/4"	.42	.88 [22]	.48 [12]	1.39 [35]	.75 [19]	.27 [7]	2.60 [66]	.31 [8]	.11 [3]	10	BROWN	1		W2CRT(1) W2CVT(1)	W2CRT(1) W2CVT(1)	W2CVT(1) W2CRT(1)	X2CRT (1)	W2CRT(1) W2CVT(1)	U2CRT (1)	----	15/16"	
YA2CL2NT14E1	N60	#2 STR	2	1/4"	.42	.88 [22]	.48 [12]	1.64 [42]	1.00 [25]	.27 [7]	2.84 [72]	.31 [8]	.11 [3]	10	BROWN	1	W2CRT(1) W2CVT(1)	W2CRT(1) W2CVT(1)	W2CVT(1) W2CRT(1)	X2CRT (1)	W2CRT(1) W2CVT(1)	U2CRT (1)	----	15/16"		
YA2CLNT516	N60	#2 STR	1	5/16"	.42	.88 [22]	.49 [12]	.62 [16]	----	.33 [8]	1.82 [46]	.25 [6]	.11 [3]	10	BROWN	1	W2CRT(1) W2CVT(1)	W2CRT(1) W2CVT(1)	W2CVT(1) W2CRT(1)	X2CRT (1)	W2CRT(1) W2CVT(1)	U2CRT (1)	----	15/16"		
YA1CLNT10	N75	#1 STR	1	8-10	.46	.88 [22]	.50 [13]	.94 [24]	----	.20 [5]	2.23 [57]	.25 [6]	.10 [3]	11 OR 375	GREEN	1	W1CRT(1) W1CVT(1)	W1CRT(1) W1CVT(1)	W1CVT(1) W1CRT(1)	X1CRT (1)	W1CRT(1) W1CVT(1)	U1CRT-1 (1)	----	15/16"		
YA1CLNT14	N75	#1 STR	1	1/4"	.46	.88 [22]	.50 [13]	.94 [24]	----	.27 [7]	2.23 [57]	.25 [6]	.10 [3]	11 OR 375	GREEN	1	W1CRT(1) W1CVT(1)	W1CRT(1) W1CVT(1)	W1CVT(1) W1CRT(1)	X1CRT (1)	W1CRT(1) W1CVT(1)	U1CRT-1 (1)	----	15/16"		
YA1CL2NT14	N75	#1 STR	2	1/4"	.46	.88 [22]	.50 [13]	1.26 [32]	.63 [16]	.27 [7]	2.55 [65]	.31 [8]	.11 [3]	11 OR 375	GREEN	1	W1CRT(1) W1CVT(1)	W1CRT(1) W1CVT(1)	W1CVT(1) W1CRT(1)	X1CRT (1)	W1CRT(1) W1CVT(1)	U1CRT-1 (1)	----	15/16"		
YA1CL2NT14E2	N75	#1 STR	2	1/4"	.46	.88 [22]	.50 [13]	1.39 [35]	.75 [19]	.27 [7]	2.68 [68]	.31 [8]	.10 [3]	11 OR 375	GREEN	1	W1CRT(1) W1CVT(1)	W1CRT(1) W1CVT(1)	W1CVT(1) W1CRT(1)	X1CRT (1)	W1CRT(1) W1CVT(1)	U1CRT-1 (1)	----	15/16"		
YA25LNT10	N100	1/0 STR	1	8-10	.51	.88 [22]	.62 [16]	.94 [24]	----	.20 [5]	2.28 [58]	.33 [8]	.12 [3]	12 OR 348	PINK	2	W25RT(2) W25VT(2)	W25RT(2) W25VT(2)	W25VT(2) W25RT(2)	X25RT (2)	W25RT(2) W25VT(2)	U25RT (1)	----	15/16"		
YA25LNT14	N100	1/0 STR	1	1/4"	.51	.88 [22]	.48 [12]	.67 [17]	----	.27 [7]	1.93 [49]	.31 [8]	.12 [3]	12 OR 348	PINK	2	W25RT(2) W25VT(2)	W25RT(2) W25VT(2)	W25VT(2) W25RT(2)	X25RT (2)	W25RT(2) W25VT(2)	U25RT (1)	----	15/16"		
YA25LNT516	N100	1/0 STR	1	5/16"	.51	.88 [22]	.62 [16]	.94 [24]	----	.33 [8]	2.28 [58]	.33 [8]	.12 [3]	12 OR 348	PINK	2	W25RT(2) W25VT(2)	W25RT(2) W25VT(2)	W25VT(2) W25RT(2)	X25RT (2)	W25RT(2) W25VT(2)	U25RT (1)	----	15/16"		
YA25LNT38	N100	1/0 STR	1	8-10	.51	.88 [22]	.62 [16]	.85 [22]	----	.41 [10]	2.18 [55]	.41 [10]	.12 [3]	12 OR 348	PINK	2	W25RT(2) W25VT(2)	W25RT(2) W25VT(2)	W25VT(2) W25RT(2)	X25RT (2)	W25RT(2) W25VT(2)	U25RT (1)	----	15/16"		
YA25L2NT14	N100	1/0 STR	2	1/4"	.51	.88 [22]	.48 [12]	1.30 [33]	.63 [16]	.27 [7]	2.56 [65]	.31 [8]	.12 [3]	12 OR 348	PINK	2	W25RT(2) W25VT(2)	W25RT(2) W25VT(2)	W25VT(2) W25RT(2)	X25RT (2)	W25RT(2) W25VT(2)	U25RT (1)	----	15/16"		
YA25L2NT14E1	N100	1/0 STR	2	1/4"	.51	.88 [22]	.48 [12]	1.94 [49]	1.00 [25]	.27 [7]	3.28 [83]	.25 [6]	.12 [3]	12 OR 348	PINK	2	W25RT(2) W25VT(2)	W25RT(2) W25VT(2)	W25VT(2) W25RT(2)	X25RT (2)	W25RT(2) W25VT(2)	U25RT (1)	----	15/16"		

- NOTES:
- MATERIAL: COPPER TUBING.
 - FINISH: TIN PLATED.
 - CAT NO. PT6515 ADAPTOR IS REQUIRED TO USE "U" DIES IN Y45 SERIES TOOLS.
 - CAT NO. PUADP-1 ADAPTOR IS REQUIRED TO USE "U" DIES IN Y46 SERIES TOOLS.
 - DUE TO LIMITED SPACE, NAVY & COLOR STAMPING WILL NOT APPEAR ON TONGUE OF YA2CL THRU YA26L.
 - DIMENSIONS IN BRACKETS [] ARE IN MILLIMETERS ROUNDED OFF TO THE NEAREST MILLIMETER, UNLESS OTHERWISE NOTED, AND ARE FOR REFERENCE ONLY.
 - FOR UNPLATED VERSIONS ADD SUFFIX "BR" TO THE CATALOG NUMBER, NICKEL PLATED VERSIONS ADD SUFFIX "NK", SILVER PLATED VERSIONS ADD SUFFIX "SV", AND FOR UNDRILLED VERSIONS ADD SUFFIX "U".
 - THESE PARTICULAR CAT. NO'S ARE AVAILABLE IN 45° AND 90° ANGLES. ALL DIMENSIONS ARE THE SAME EXCEPT FOR THOSE SPECIFIED ON SHEET 3 & 4.
 - DIELESS TOOL AND NO OF CRIMPS FOR YA8CL TO YA6CL: YIMRTC(1), Y122CMR(1), PAT81KFT(1), Y81KFT(1).
 - "X" DIE SETS ALSO WORK IN THE BCT500, Y500CT & PAT600 SERIES TOOLS.

TOLERANCE BLOCK							
CAT.NO.	B	C	K	L	N	O.D	T
YA8C THRU YA25	±.06	+ .04 - .02	±.02	±.09	±.03	±.01	±.03
YA26 THRU YA34	±.08	+ .04 - .02	±.02	±.12	±.03	±.01	±.04
YA34 AND UP	±.09	±.06	±.02	±.15	±.06	±.01	±.04

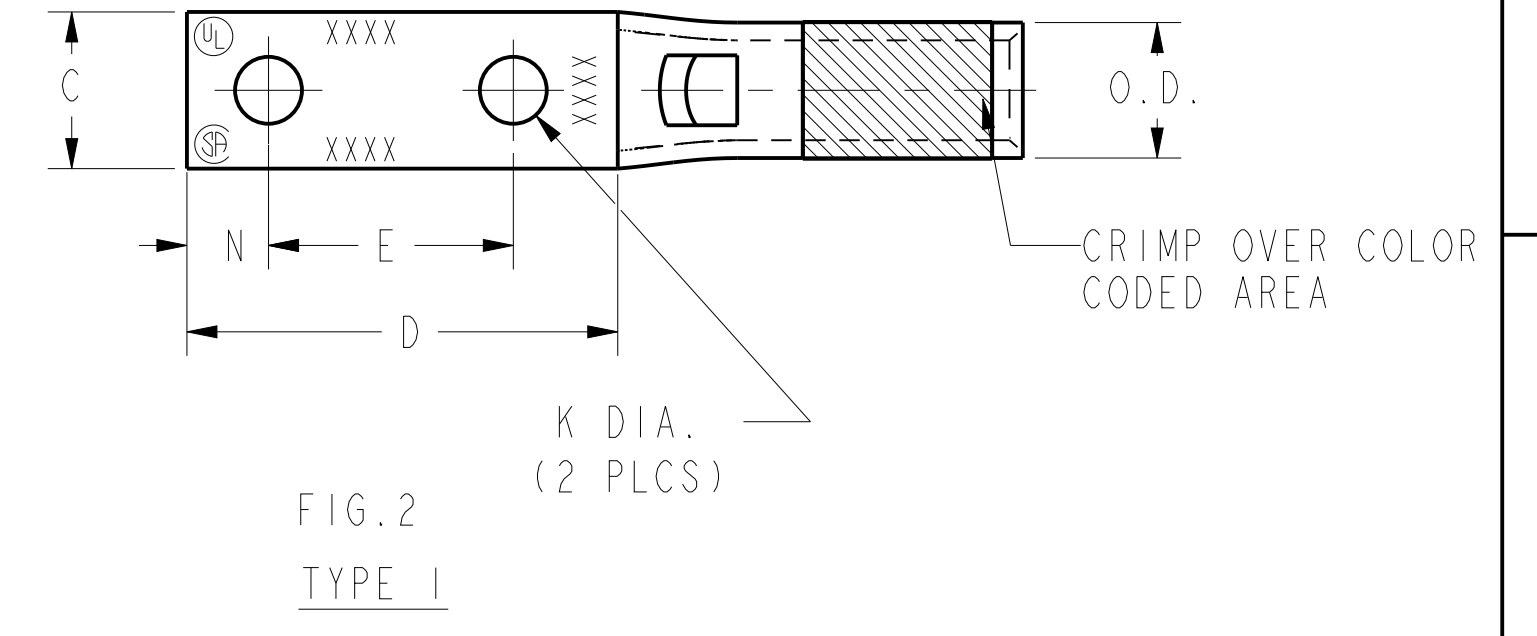
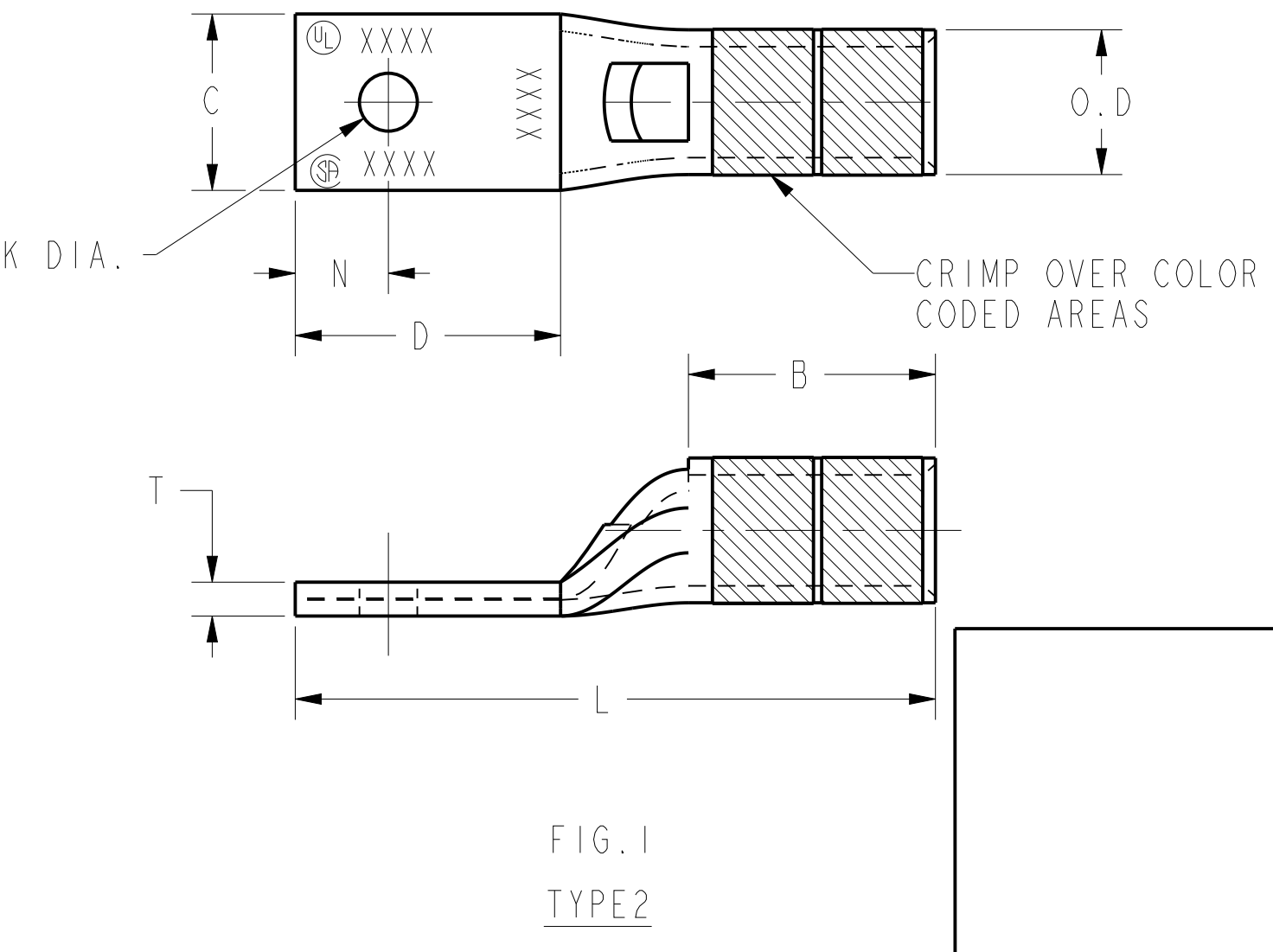

HYLUG™ COPPER (NARROW TONGUE)

ITEM NO:	N/A
CAT. NO:	YA-L-NT-(TABLE)
DRAWN BY:	JRC 01/05/89
CHECKER:	K. HENRY 01/09/89
DSN APPVL:	RM 01/12/89
MFG APPVL:	N/A
QA APPVL:	F. RUMFELT 01/16/89
MKT APPVL:	--
PROD FAM:	--
PROJECT #:	--
DOCUMENT TYPE:	Sales
REL LEVEL:	Released

SCALE: 1:1

DRAWING NO: SD201517

SHEET 1 OF 4

REV: T

REV	DATE	DESCRIPTION	ECO	BY	C'H'K.
T	03/16/2015 00:00:00 AM	ADDING CAT. NO#YA1CLNT1490 TO TABLE IN SHEET 3	39440	AS	MB

REV: PEO200